

113 年度高雄市甲仙區地籍圖重測區
都市計畫樁測量成果案



高雄市政府

中華民國 113 年 5 月

113 年度高雄市甲仙區地籍圖重測區 都市計畫樁測量成果案

1. 坐標轉換成果
2. 圖根測量坐標成果表
3. 都市計畫樁坐標成果表
4. 都市計畫樁新舊坐標對照表
5. 都市計畫樁位指示圖
6. 都市計畫樁位公告圖
7. 都市計畫樁位圖

1. 坐標轉換成果

 *
 * HELMERT 四參數轉換 *
 *
 * VERSION 1.2 2001.01. *

資料名稱 : helmert from TWD67-TWD97@2020

檔案名稱 : 1130516.DAT

計算日期時間 : 2024/ 5/17 8:23

[控制點轉換平差成果]

點名	轉換前(N,E)座標		轉換後(N,E)座標		不符值	
1 BA122	2552499.427	206079.354	2552291.574	206907.158	-0.005	0.001
2 BA421	2553095.509	206388.577	2552887.654	207216.360	0.000	-0.001
3 BA422	2553135.752	206384.746	2552927.902	207212.526	-0.006	0.001
4 BA78	2552755.200	206312.734	2552547.337	207140.533	0.009	-0.005
5 BA89	2553081.146	206431.767	2552873.291	207259.546	0.002	0.003

比例尺= 0.9999890 中誤差= 0.0000090 t=0.12E+01
 旋轉量= + 0d 0m 6.7s 中誤差= 0.0000090 t=0.36E+01
 N軸平移量= -186.470 中誤差= 22.957 t=0.81E+01
 E軸平移量= 912.377 中誤差= 22.957 t=0.40E+02
 單位權中誤差= 0.00557 漸近次數= 2 自由度= 6

[未知點轉換成果]

點名	轉換前(N,E)座標		轉換後(N,E)座標	
C1	2552489.525	206084.128	2552281.667	206911.933
C2	2552646.790	206170.017	2552438.930	206997.815
C227-1	2552701.428	206485.513	2552493.578	207313.309
RF12	2553234.234	206075.776	2553026.367	206903.559
RF13	2552502.265	206016.330	2552294.405	206844.132
RF14	2552439.311	206349.868	2552231.456	207177.674

RF15	2552522.770	206383.420	2552314.917	207211.222
RF16	2552637.622	206531.849	2552429.772	207359.648
RF17	2552704.333	206595.120	2552496.484	207422.916
RF17-2	2552694.424	206585.660	2552486.574	207413.456
RF18	2552764.248	206665.475	2552556.406	207493.264
RF19	2552893.480	206741.530	2552685.639	207569.320
RF19-2	2552891.394	206740.270	2552683.549	207568.060
M106	2552654.577	206439.434	2552446.726	207267.231
M107	2552600.490	206483.862	2552392.640	207311.661
M108	2552642.506	206536.476	2552434.658	207364.274
R35	2553054.312	206984.214	2552846.478	207811.998

2. 圖根測量坐標成果表

EH0000				
BH03	2553081.203	207189.429		0.000
BI001	2552792.000	206984.789		0.000
BI002	2552730.014	206965.468		0.000
BI003	2552648.669	206970.463		0.000
BI004	2552572.920	206999.283		0.000
BI005	2552461.056	206992.556		0.000
BI006	2552274.811	206919.061		0.000
BI007	2552156.892	206834.325		0.000
BI008	2552126.500	206817.659		0.000
BI009	2552108.870	206747.407		0.000
BI010	2552122.680	206708.964		0.000
BI011	2552050.589	206796.208		0.000
BI012	2551956.818	206740.324		0.000
BI013	2551866.378	206646.408		0.000
BI014	2551801.793	206630.452		0.000
BI015	2551726.690	206539.477		0.000
BI016	2551720.403	206475.287		0.000
BI017	2551754.370	206423.184		0.000
BI018	2551740.871	206342.696		0.000
BI019	2551807.099	206363.609		0.000
BI020	2551842.752	206346.812		0.000
BI021	2551637.938	206471.008		0.000
BI022	2551579.534	206409.204		0.000
BI023	2551527.875	206329.562		0.000
BI024	2551422.112	206246.747		0.000
BI025	2551304.304	206119.556		0.000
BI026	2551236.498	206024.416		0.000
BI027	2551176.992	205978.950		0.000
BI028	2551105.708	205885.444		0.000
BI029	2550963.362	205694.997		0.000
BI030	2550952.779	205605.478		0.000
BI031	2550927.914	205555.968		0.000
BI032	2550928.505	205505.082		0.000
BI033	2550905.676	205468.301		0.000
BI034	2550895.346	205379.649		0.000
BI035	2550817.359	205215.239		0.000
BI036	2550782.709	205104.905		0.000
BI037	2550728.301	204966.893		0.000
BI038	2550581.917	204910.041		0.000
BI039	2550547.831	204857.673		0.000
BI040	2550381.303	204833.595		0.000
BI041	2550224.415	204826.176		0.000
BI042	2550072.114	204823.138		0.000

BI043	2550038.942	204777.907	0.000
BI044	2549978.086	204687.069	0.000
BI045	2549957.509	204624.150	0.000
BI046	2549905.659	204549.096	0.000
BI047	2549901.995	204520.891	0.000
BI048	2549876.552	204470.954	0.000
BI049	2549816.636	204409.067	0.000
BI050	2549773.539	204373.212	0.000
BI051	2549684.489	204327.251	0.000
BI052	2549593.724	204241.952	0.000
BI053	2549495.112	204179.324	0.000
BI054	2549368.011	204095.339	0.000
BI055	2549302.726	204063.842	0.000
BI056	2549189.806	203947.594	0.000
BI057	2552222.834	204939.685	0.000
BI058	2549015.125	204019.154	0.000
BI059	2549074.973	204046.079	0.000
BI060	2549149.038	204082.624	0.000
BI061	2549234.281	204194.911	0.000
BI062	2549298.953	204275.021	0.000
BI063	2549356.252	204387.619	0.000
BI064	2549345.100	204429.251	0.000
BI065	2549341.132	204476.030	0.000
BI066	2549409.822	204495.358	0.000
BI067	2549468.970	204548.631	0.000
BI068	2549502.141	204602.773	0.000
BI069	2549482.001	204629.169	0.000
BI070	2549460.758	204689.386	0.000
BI071	2549321.610	204646.705	0.000
BI072	2549273.503	204354.953	0.000
BI073	2549271.379	204396.283	0.000
BI074	2549203.626	204395.935	0.000
BI075	2549185.653	204419.903	0.000
BI076	2549125.019	204409.333	0.000
BI077	2549085.009	204459.873	0.000
BI078	2549073.930	204503.742	0.000
BI079	2549041.009	204510.002	0.000
BI080	2548920.493	204478.809	0.000
BI081	2549698.478	204418.573	0.000
BI082	2549700.652	204514.298	0.000
BI083	2549721.237	204542.254	0.000
BI084	2549750.191	204598.957	0.000
BI085	2549790.803	204694.582	0.000
BI086	2549830.273	204746.525	0.000

BI087	2549829.912	204812.715	0.000
BI088	2549830.205	204877.562	0.000
BI089	2549840.759	204943.796	0.000
BI090	2549902.086	205022.312	0.000
BI091	2549950.688	205091.261	0.000
BI092	2550010.186	205187.120	0.000
BI093	2549992.357	205275.931	0.000
BI094	2550011.812	205356.959	0.000
BI095	2549948.003	205328.731	0.000
BI096	2549977.351	205459.211	0.000
BI097	2549924.106	205552.995	0.000
BI098	2549920.579	205613.536	0.000
BI099	2549965.564	205772.873	0.000
BI100	2550036.011	205867.990	0.000
BI101	2550141.132	206106.372	0.000
BI102	2550145.055	206167.752	0.000
BI103	2550157.100	206230.571	0.000
BI104	2550183.463	206310.165	0.000
BI105	2550181.868	206368.326	0.000
BI106	2550172.873	206416.610	0.000
BI107	2550187.273	206472.337	0.000
BI108	2550212.379	206509.108	0.000
BI109	2550232.281	206547.182	0.000
BI110	2550236.758	206583.818	0.000
BI111	2550320.637	206895.824	0.000
BI112	2550210.311	206165.378	0.000
BI113	2550219.568	206207.726	0.000
BI114	2550280.478	206222.505	0.000
BI115	2550292.008	206263.750	0.000
BI116	2550259.445	206317.287	0.000
BI117	2550320.356	206336.299	0.000
BI118	2550369.341	206403.147	0.000
BI119	2550433.540	206508.381	0.000
BI120	2550489.137	206548.557	0.000
BI121	2550567.665	206678.181	0.000
BI122	2550581.008	206741.657	0.000
BI123	2550626.024	206720.330	0.000
BI124	2550649.482	206715.135	0.000
BI125	2550883.877	206470.708	0.000
BI126	2549972.385	205155.745	0.000
BI127	2549938.979	205099.435	0.000
BI128	2549914.116	205067.508	0.000
BI129	2549839.679	204971.373	0.000
BI130	2549777.525	204984.909	0.000

BI131	2549745.270	205012.396	0.000
BI132	2549768.380	205051.083	0.000
BI133	2549814.535	205081.125	0.000
BI134	2549820.532	205102.341	0.000
BI135	2549823.674	205126.388	0.000
BI136	2549833.994	205157.597	0.000
BI137	2549853.272	205181.902	0.000
BI138	2549897.713	205153.061	0.000
BI139	2549764.487	205122.137	0.000
BI140	2549710.777	205154.467	0.000
BI141	2549622.309	205190.443	0.000
BI142	2549674.038	205170.086	0.000
BI143	2549653.559	205148.673	0.000
BI144	2549628.636	205107.464	0.000
BI145	2549636.210	205077.966	0.000
BI146	2549668.223	205073.097	0.000
BI147	2549697.739	205043.978	0.000
BI148	2549727.750	205029.064	0.000
BI149	2549709.430	204994.579	0.000
BI150	2549708.114	204965.575	0.000
BI151	2549690.019	204936.046	0.000
BI152	2549673.152	204906.338	0.000
BI153	2549676.005	204884.171	0.000
BI154	2549518.372	204734.480	0.000
BI155	2549684.991	204523.195	0.000
BI156	2549661.885	204546.531	0.000
BI157	2549581.212	204489.969	0.000
BI158	2549765.145	205184.958	0.000
BI159	2549772.555	205209.193	0.000
BI160	2549761.501	205242.200	0.000
BI161	2549768.596	205281.296	0.000
BI162	2549789.122	205334.131	0.000
BI163	2549810.036	205371.436	0.000
BI164	2549919.182	205328.767	0.000
BI165	2549841.922	205428.477	0.000
BI166	2549872.896	205474.129	0.000
BI167	2549842.292	205493.787	0.000
BI168	2549859.731	205524.183	0.000
BI169	2549880.056	205557.850	0.000
BI170	2549897.689	205597.107	0.000
BI171	2549949.147	205395.656	0.000
BI172	2549988.209	205481.888	0.000
BI173	2549989.199	205498.197	0.000
BI174	2550010.958	205550.482	0.000

BI175	2550026.119	205590.187	0.000
BI176	2550056.199	205618.367	0.000
BI177	2550060.713	205636.106	0.000
BI178	2550044.906	205656.940	0.000
BI179	2550080.425	205714.137	0.000
BI180	2550131.617	205817.453	0.000
BI181	2550172.601	205886.318	0.000
BI182	2550194.713	205930.658	0.000
BI183	2550234.894	206011.140	0.000
BI184	2550258.548	206054.049	0.000
BI185	2550285.709	206107.311	0.000
BI186	2550316.951	206169.414	0.000
BI187	2550326.538	206198.265	0.000
BI188	2550357.587	206227.015	0.000
BI189	2550392.762	206291.909	0.000
BI190	2550423.399	206341.312	0.000
BI191	2550410.050	206364.588	0.000
BI192	2550366.611	206356.279	0.000
BI193	2550323.177	206321.166	0.000
BI194	2550285.710	206324.366	0.000
BI195	2549929.386	204726.531	0.000
BI196	2549886.303	204761.302	0.000
BI197	2549853.636	204707.104	0.000
BI198	2549830.562	204673.079	0.000
BI199	2549797.306	204633.784	0.000
BI200	2549772.841	204581.848	0.000
BI201	2549739.499	204528.454	0.000
BI202	2549795.729	204501.529	0.000
BI203	2549827.646	204490.607	0.000
BI204	2549729.281	204482.087	0.000
BI205	2549833.827	204550.282	0.000
BI206	2549861.470	204663.772	0.000
BI207	2549912.696	204643.604	0.000
BI208	2549909.147	204809.206	0.000
BI209	2549933.511	204847.656	0.000
BI210	2549947.178	204880.715	0.000
BI211	2549962.510	204895.971	0.000
BI212	2549981.041	204935.889	0.000
BI213	2549990.766	204890.677	0.000
BI214	2550044.619	204870.714	0.000
BI215	2550113.361	204870.927	0.000
BI216	2550155.124	204968.305	0.000
BI217	2550186.689	204985.375	0.000
BI218	2550209.781	205072.700	0.000

BI219	2550230.356	205136.224	0.000
BI220	2550249.875	205204.283	0.000
BI221	2550282.241	205334.353	0.000
BI222	2550280.721	205429.216	0.000
BI223	2550280.497	205514.553	0.000
BI224	2550309.563	205589.484	0.000
BI225	2550356.964	205708.088	0.000
BI226	2550386.377	205781.806	0.000
BI227	2550428.495	205844.796	0.000
BI228	2550469.092	205921.747	0.000
BI229	2550518.349	206038.569	0.000
BI230	2550234.354	205544.236	0.000
BI231	2550190.328	205571.242	0.000
BI232	2550173.830	205562.554	0.000
BI233	2550165.195	205524.598	0.000
BI234	2550151.319	205501.225	0.000
BI235	2550136.568	205444.154	0.000
BI236	2550133.542	205406.078	0.000
BI237	2550121.475	205335.349	0.000
BI238	2550159.493	205328.749	0.000
BI239	2550203.016	205313.061	0.000
BI240	2550268.860	205278.362	0.000
BI241	2550018.774	204341.895	0.000
BI242	2549992.118	204269.568	0.000
BI243	2549936.078	204200.876	0.000
BI244	2549867.296	204147.175	0.000
BI245	2549722.155	204043.595	0.000
BI246	2549687.626	203999.620	0.000
BI247	2549603.091	203924.299	0.000
BI248	2549553.193	203977.573	0.000
BI249	2549520.030	204024.872	0.000
BI250	2549471.432	204086.264	0.000
BI251	2550718.415	204905.808	0.000
BI252	2550675.455	204819.379	0.000
BI253	2550668.547	204735.479	0.000
BI254	2550629.118	204643.252	0.000
BI255	2550621.153	204594.125	0.000
BI256	2550610.434	204535.169	0.000
BI257	2550610.503	204454.973	0.000
BI258	2550585.018	204323.855	0.000
BI259	2550512.077	204161.669	0.000
BI260	2550486.901	204119.696	0.000
BI261	2550463.607	204055.617	0.000
BI262	2550412.274	203983.354	0.000

BI263	2550332.528	203896.540	0.000
BI264	2550330.011	203835.964	0.000
BI265	2550342.870	203770.737	0.000
BI266	2550364.616	203726.419	0.000
BI267	2550346.254	203671.671	0.000
BI268	2550255.445	203582.613	0.000
BI269	2550174.246	203459.903	0.000
BI270	2550072.430	203380.121	0.000
BI271	2550019.466	203400.185	0.000
BI272	2550294.484	204456.422	0.000
BI273	2550333.272	204540.261	0.000
BI274	2550343.575	204610.771	0.000
BI275	2550400.744	204759.550	0.000
BI276	2550442.788	204820.456	0.000
BI277	2550497.269	204256.330	0.000
BI278	2550453.595	204274.374	0.000
BI279	2550419.442	204288.579	0.000
BI280	2550355.936	204233.097	0.000
BI281	2550420.235	204146.687	0.000
BI282	2550359.010	204156.547	0.000
BI283	2550345.694	204102.253	0.000
BI284	2550328.805	204060.065	0.000
BI285	2550275.387	204062.360	0.000
BI286	2550253.957	203928.341	0.000
BI287	2550549.154	204776.884	0.000
BI288	2550553.107	204719.214	0.000
BI289	2550649.409	204700.513	0.000
BI290	2550561.274	204606.772	0.000
BI291	2550556.424	204565.529	0.000
BI292	2550523.726	204584.075	0.000
BI293	2550511.982	204503.850	0.000
BI294	2550498.160	204487.414	0.000
BI295	2550548.009	204466.466	0.000
BI296	2550282.649	204403.212	0.000
BI297	2550244.752	204341.999	0.000
BI298	2550201.523	204177.063	0.000
BI299	2550174.332	204073.017	0.000
BI300	2550223.032	204012.024	0.000
BI301	2550203.305	203902.692	0.000
BI302	2550203.060	203839.249	0.000
BI303	2550191.743	203806.886	0.000
BI304	2550160.594	203763.420	0.000
BI305	2550139.722	203655.983	0.000
BI306	2550460.771	204362.870	0.000

BI307	2550974.119	205607.680	0.000
BI308	2550998.334	205605.430	0.000
BI309	2551003.677	205582.972	0.000
BI310	2550992.987	205550.933	0.000
BI311	2550988.533	205524.175	0.000
BI312	2550993.422	205500.901	0.000
BI313	2550993.270	205467.678	0.000
BI314	2550958.999	205465.597	0.000
BI315	2550979.882	205434.864	0.000
BI316	2550965.528	205407.735	0.000
BI317	2550986.850	205412.688	0.000
BI318	2551012.486	205414.986	0.000
BI319	2551040.523	205415.069	0.000
BI320	2551080.973	205478.361	0.000
BI321	2552928.054	207212.502	0.000
BI322	2552727.721	207145.896	0.000
BI323	2552629.822	207083.038	0.000
BI324	2552224.826	206968.332	0.000
BI325	2552163.494	207037.737	0.000
BI326	2552123.185	207038.013	0.000
BI327	2552075.006	207052.028	0.000
BI328	2552305.719	207179.215	0.000
BI329	2552405.498	207116.856	0.000
BI330	2552395.175	207098.802	0.000
BI331	2551852.688	206926.738	0.000
BI332	2551814.883	206915.378	0.000
BI333	2551794.249	206874.500	0.000
BI334	2551789.636	206817.371	0.000
BI335	2551827.565	206717.278	0.000
BI336	2551781.120	206759.319	0.000
BI337	2551731.459	206764.410	0.000
BI338	2551661.386	206777.239	0.000
BI339	2551632.772	206770.152	0.000
BI340	2551560.214	206781.177	0.000
BI341	2551523.721	206766.836	0.000
BI342	2551475.010	206783.163	0.000
BI343	2551432.368	206828.028	0.000
BI344	2551560.705	206431.332	0.000
BI345	2551569.150	206449.984	0.000
BI346	2551523.603	206514.279	0.000
BI347	2551409.853	206274.704	0.000
BI348	2551426.807	206290.484	0.000
BI349	2551406.955	206310.789	0.000
BI350	2551384.284	206338.008	0.000

BI351	2551419.487	206414.562	0.000
BI352	2551444.245	206469.555	0.000
BI353	2551540.054	206531.952	0.000
BI354	2551637.705	206587.923	0.000
BI355	2551649.004	206669.056	0.000
BI356	2551595.666	206696.179	0.000
BI357	2551502.018	206674.463	0.000
BI358	2551510.047	206718.173	0.000
BI359	2551500.930	206535.321	0.000
BI360	2552963.452	207475.853	0.000
BI361	2552855.290	207501.438	0.000
BI362	2552780.524	207531.160	0.000
BI363	2552685.478	207572.023	0.000
BI364	2552569.275	207504.831	0.000
BI365	2552458.970	207393.815	0.000
BI366	2551102.398	205733.679	0.000
BI367	2551060.623	205712.846	0.000
BI368	2551009.444	205682.731	0.000
BI369	2551263.235	205673.632	0.000
BI370	2551265.635	205747.994	0.000
BI371	2551264.849	205771.599	0.000
BI372	2551241.920	205779.082	0.000
BI373	2551210.647	205754.554	0.000
BI374	2551173.416	205743.253	0.000
BI375	2551320.299	205544.724	0.000
BI376	2551404.841	205546.378	0.000
BI377	2551414.362	206056.179	0.000
BI378	2551378.594	205975.903	0.000
BI379	2551449.955	206196.717	0.000
BI380	2551502.028	206176.796	0.000
BI381	2551500.815	206222.971	0.000
BI382	2551553.929	206266.763	0.000
BI383	2551578.248	206306.550	0.000
BI384	2551575.284	206324.782	0.000
BI385	2551478.808	206151.835	0.000
BI386	2551453.813	206089.845	0.000
BI387	2551382.302	206178.425	0.000
BI388	2551518.302	206164.716	0.000
BI389	2551565.543	206169.723	0.000
BI390	2551581.799	206189.305	0.000
BI391	2551572.001	206212.153	0.000
BI392	2551571.678	206194.894	0.000
BI393	2551542.088	206176.578	0.000
BI394	2551412.874	206877.938	0.000

BI395	2551511.664	206902.252	0.000
BI396	2551611.913	206956.247	0.000
BI397	2551656.312	206967.632	0.000
BI398	2551695.965	206959.527	0.000
BI399	2551732.783	206971.517	0.000
BI400	2551741.932	206941.416	0.000
BI401	2551762.798	206923.320	0.000
BI402	2551777.996	206912.755	0.000
BI403	2551618.229	206937.922	0.000
BI404	2551597.623	206872.785	0.000
BI405	2551671.055	206798.489	0.000
BI406	2551551.773	206866.577	0.000
BI407	2552435.485	206727.631	0.000
BI408	2552478.916	206677.221	0.000
BI409	2552539.910	206680.802	0.000
BI410	2552579.929	206702.213	0.000
BI411	2552590.575	206740.206	0.000
BI412	2551533.162	205899.978	0.000
BI413	2551557.257	205968.381	0.000
BI414	2551567.165	206002.241	0.000
BI415	2551556.095	206013.583	0.000
BI416	2551531.117	206052.629	0.000
BI417	2551508.331	206042.286	0.000
BI418	2551500.542	206066.592	0.000
BI419	2551495.954	206098.361	0.000
BI420	2551482.158	206120.797	0.000
BI421	2551474.871	206140.485	0.000
BI422	2552014.130	206776.582	0.000
BI423	2552254.589	207006.115	0.000
BI424	2552267.607	207043.516	0.000
BI425	2552237.845	207069.187	0.000
BI426	2552251.080	207089.885	0.000
BI427	2552217.461	207140.080	0.000
BI428	2552051.302	207098.186	0.000
BI429	2551917.810	207012.699	0.000
BI430	2551881.171	206951.943	0.000
BI431	2551331.091	205933.865	0.000
BI432	2551276.479	205840.143	0.000
BI433	2551135.723	205742.407	0.000
BI434	2551113.036	205669.018	0.000
BI435	2551156.190	205603.260	0.000
BI436	2551219.104	205531.927	0.000
BI437	2551235.139	205437.591	0.000
BI438	2551345.104	205363.129	0.000

BI439	2551354.368	205304.161	0.000
BI440	2551309.505	205220.649	0.000
BI441	2551178.440	205153.054	0.000
BI442	2551172.218	205058.496	0.000
BI443	2551125.897	204983.370	0.000
BI444	2551118.097	204810.386	0.000
BI445	2551167.584	204764.562	0.000
BI446	2551248.800	204761.333	0.000
BI447	2551356.106	204703.726	0.000
BI448	2551390.016	204653.481	0.000
BI449	2551411.187	204585.619	0.000
BI450	2551460.193	204545.378	0.000
BI451	2551466.503	204502.196	0.000
BI452	2551440.318	204460.302	0.000
BI453	2551385.355	204429.282	0.000
BI454	2551362.691	204390.538	0.000
BI455	2551593.602	204507.145	0.000
BI456	2551667.072	204492.291	0.000
BI457	2551703.038	204455.330	0.000
BI458	2551753.814	204456.105	0.000
BI459	2551787.745	204445.440	0.000
BI460	2551785.476	204469.939	0.000
BI461	2551752.664	204515.330	0.000
BI462	2551723.510	204528.444	0.000
BI463	2551716.359	204550.535	0.000
BI464	2551734.730	204340.968	0.000
BI465	2551784.510	204327.775	0.000
BI466	2551880.529	204304.455	0.000
BI467	2551882.500	204236.396	0.000
BI468	2551943.628	204215.008	0.000
BI469	2552027.374	204218.566	0.000
BI470	2551823.100	204551.569	0.000
BI471	2551792.084	204617.444	0.000
BI472	2551839.190	204682.016	0.000
BI473	2551884.306	204770.943	0.000
BI474	2551885.888	204810.339	0.000
BI475	2551906.746	204841.379	0.000
BI476	2551931.935	204881.927	0.000
BI477	2551939.740	204967.754	0.000
BI478	2551966.557	204945.991	0.000
BI479	2551991.362	204949.550	0.000
BI480	2552001.774	204919.570	0.000
BI481	2552141.824	204946.627	0.000
BI482	2552194.316	204949.301	0.000

BI483	2552259.263	204941.722	0.000
BI484	2552357.732	204916.231	0.000
BI485	2552355.080	204940.248	0.000
BI486	2552324.578	204960.093	0.000
BI487	2552283.936	205011.069	0.000
BI488	2552266.375	205045.092	0.000
BI489	2552284.272	205095.254	0.000
BI490	2552280.933	205114.406	0.000
BI491	2552252.494	205120.903	0.000
BI492	2551938.683	205017.191	0.000
BI493	2551917.207	205007.095	0.000
BI494	2551896.484	205006.217	0.000
BI495	2551797.685	205070.367	0.000
BI496	2551728.353	204254.085	0.000
BI497	2551676.398	204260.647	0.000
BI498	2551631.320	204272.527	0.000
BI499	2551612.215	204292.205	0.000
BI500	2551619.720	204355.892	0.000
BI501	2549438.717	204121.153	0.000
BI502	2549780.416	204346.096	0.000
BI503	2549849.614	204278.998	0.000
BI504	2549813.741	204231.592	0.000
BI505	2549740.795	204183.932	0.000
BI506	2549651.198	204167.783	0.000
BI507	2549608.336	204147.914	0.000
BI508	2549587.049	204195.303	0.000
BI509	2549853.979	204439.210	0.000
BI510	2549926.607	204402.137	0.000
BI511	2549912.405	204346.836	0.000
BI512	2549882.278	204315.455	0.000
BI513	2549323.580	204069.719	0.000
BI514	2549287.815	204007.656	0.000
BI515	2549228.190	203920.116	0.000
BI516	2549248.367	203909.300	0.000
BI517	2549258.805	203869.645	0.000
BI518	2549280.211	203855.927	0.000
BI519	2549242.504	203771.395	0.000
BI520	2549248.790	203746.879	0.000
BI521	2549285.431	203725.501	0.000
BI522	2549364.122	203685.011	0.000
BI523	2549416.025	203651.062	0.000
BI524	2549460.197	203636.537	0.000
BI525	2552745.268	204940.746	0.000
BI526	2552760.333	204945.060	0.000

BI527	2552768.520	204971.804	0.000
BI528	2552802.177	205014.109	0.000
BI529	2552797.693	205070.927	0.000
BI530	2552811.121	205126.264	0.000
BI531	2552784.331	205148.178	0.000
BI532	2552754.683	205186.800	0.000
BI533	2552725.751	205207.203	0.000
BI534	2552278.820	205371.947	0.000
BI535	2552252.121	205328.301	0.000
BI536	2552226.700	205335.122	0.000
BI537	2552179.288	205365.442	0.000
BI538	2552122.421	205384.794	0.000
BI539	2552063.270	205378.661	0.000
BI540	2552098.485	205334.451	0.000
BI541	2552141.776	205306.749	0.000
BI542	2552176.461	205226.591	0.000
BI543	2552207.213	205212.307	0.000
BI544	2552263.302	205208.806	0.000
BI545	2552242.250	205159.510	0.000
BI546	2552219.896	205164.831	0.000
BI547	2552184.288	205122.260	0.000
BI548	2552210.467	205055.529	0.000
BI549	2552183.924	205017.437	0.000
BI550	2552145.756	204971.715	0.000
BI551	2552105.572	204964.064	0.000
BI552	2552074.536	204901.198	0.000
BI553	2552043.633	204903.790	0.000
BI554	2552309.607	204912.722	0.000
BI555	2549464.163	203660.116	0.000
BI556	2549509.495	203686.779	0.000
BI557	2549550.780	203735.040	0.000
BI558	2549489.809	203743.724	0.000
BI559	2549434.965	203759.192	0.000
BI560	2549264.351	203809.920	0.000
BI561	2549552.585	203768.693	0.000
BI562	2549518.604	203836.741	0.000
BI563	2549604.207	203879.341	0.000
BI564	2549630.919	203770.022	0.000
BI565	2549716.861	203865.304	0.000
BI566	2549768.031	203900.103	0.000
BI567	2549308.231	203878.903	0.000
BI568	2549323.925	203911.888	0.000
BI569	2549364.396	203959.992	0.000
BI570	2549443.905	204010.278	0.000

BI571	2552121.572	206667.373	0.000
BI572	2552047.902	206672.189	0.000
BI573	2552001.589	206642.492	0.000
BI574	2553037.934	207282.708	0.000
BI575	2551924.016	206665.132	0.000
BI576	2551882.929	206646.765	0.000
BI577	2551938.037	206618.244	0.000
BI578	2551980.037	206607.374	0.000
BI579	2551973.246	206628.308	0.000
BI580	2552002.405	206628.943	0.000
BI581	2551448.977	205579.369	0.000
BI582	2551472.784	205583.756	0.000
BI583	2551629.349	205539.249	0.000
BI584	2552143.731	206769.703	0.000
BI585	2552191.394	206836.386	0.000
BI586	2552214.297	206831.996	0.000
BI587	2552233.627	206807.877	0.000
BI588	2552271.052	206812.908	0.000
BI589	2552236.520	206850.941	0.000
BI590	2551707.090	204410.057	0.000
BI591	2552762.037	205269.723	0.000
BI592	2552779.993	205309.402	0.000
BI593	2552765.881	205329.163	0.000
BI594	2552718.551	205294.128	0.000
BI595	2552673.951	205276.513	0.000
BI596	2552597.902	205206.519	0.000
BI597	2552571.634	205227.288	0.000
BI598	2552593.123	205269.864	0.000
BI599	2552620.055	205313.396	0.000
BI600	2552559.211	205331.756	0.000
BI601	2552460.336	205309.730	0.000
BI602	2552380.363	205339.138	0.000
BI603	2552334.411	205356.513	0.000
BI604	2549846.345	203829.302	0.000
BI605	2549867.867	203840.444	0.000
BI606	2549923.858	203901.280	0.000
BI607	2549848.051	203959.370	0.000
BI608	2552517.696	207049.983	0.000
BI609	2549815.208	204683.928	0.000
BP1124	2549073.122	203887.955	0.000
BP1125	2549068.186	203911.057	0.000
BP1126	2549018.292	203943.698	0.000
BP1127	2548986.034	203983.483	0.000
EL002	2549960.054	203377.003	0.000

EL003	2549790.482	204085.973	0.000
EM090	2552141.906	204118.154	0.000
EM091	2552429.177	204375.928	0.000
EM092	2550073.779	205382.212	0.000
EM093	2549889.764	205034.165	0.000
EM094	2551681.880	204536.483	0.000
EM095	2552733.070	204929.428	0.000
EM096	2552703.374	205235.813	0.000
EM097	2552311.216	205377.529	0.000
EM098	2551364.645	204362.876	0.000
EM099	2552609.493	206773.393	0.000
EM100	2552140.094	206687.139	0.000
EM101	2551968.844	207080.278	0.000
EM102	2551406.658	206817.383	0.000
EM103	2550107.287	206003.709	0.000
EM104	2551770.948	206312.306	0.000
EM105	2551360.485	206156.335	0.000
EM106	2551011.184	205796.367	0.000
EM107	2550857.973	205308.423	0.000
EM108	2550646.633	204942.519	0.000
EM109	2551003.804	207151.784	0.000
EM110	2550216.441	204261.418	0.000
EM111	2550555.627	204245.349	0.000
EM112	2549252.611	203253.579	0.000
EM113	2551557.999	207395.628	0.000
EM115	2549444.712	203658.706	0.000
EM116	2549179.544	204128.222	0.000
EM117	2549351.567	204342.422	0.000
EM118	2550535.425	206046.325	0.000
J024	2551827.187	204326.508	0.000
J025	2551202.758	205570.415	0.000
M0580	2549753.903	204446.679	0.000
N0029	2551999.829	204229.881	0.000
X208	2552819.732	207152.181	0.000

3. 都市計畫樁坐標成果表

4. 都市計畫樁新舊坐標對照表

都市計畫樁新舊坐標對照表

計畫名稱：113年度高雄市甲仙區地籍圖重測區都市計畫樁測量成果案

測量單位：高雄市政府地政局土地開發處

測量者：黃建忠

校核者：顏啟明

製表者：黃建忠

日期：113年5月16日

共2頁 第1頁

點 號	縱 線(M)	橫 線(M)	距 離(M)	備 註
RF12	2553026.367	206903.559	734.370	
	(2553234.234)	(206075.776)	(734.379)	
RF13	2552294.405	206844.132	68.987	
	(2552502.265)	(206016.330)	(68.985)	
C1	2552281.667	206911.933	270.443	
	(2552489.525)	(206084.128)	(270.443)	
RF14	2552231.456	207177.674	89.951	
	(2552439.311)	(206349.868)	(89.951)	
RF15	2552314.917	207211.222	126.999	
	(2552522.770)	(206383.420)	(127.000)	
M107	2552392.640	207311.661	60.676	
	(2552600.490)	(206483.862)	(60.676)	
RF16	2552429.772	207359.648	6.729	
	(2552637.622)	(206531.849)	(6.728)	
M108	2552434.658	207364.274	71.513	
	(2552642.506)	(206536.476)	(71.516)	
RF17-2	2552486.574	207413.456	13.700	
	(2552694.424)	(206585.660)	(13.700)	
RF17	2552496.484	207422.916	92.409	
	(2552704.333)	(206595.120)	(92.410)	
RF18	2552556.406	207493.264	147.512	
	(2552764.248)	(206665.475)	(147.514)	
RF19-2	2552683.549	207568.060	2.440	
	(2552891.394)	(206740.270)	(2.437)	
RF19	2552685.639	207569.320	291.139	
	(2552893.480)	(206741.530)	(291.140)	
說 明	一、下欄係依市縣建設單位提供之坐標成果。以括弧標示。 二、上欄係依據內政部核定之TWD97@2020坐標系統控制點（二度分帶橫梅氏投影坐標）推算之成果。			

都市計畫樁新舊坐標對照表

計畫名稱：113年度高雄市甲仙區地籍圖重測區都市計畫樁測量成果案

測量單位：高雄市政府地政局土地開發處

測量者：黃建忠

校核者：顏啟明

製表者：黃建忠

日期：113年5月16日

共2頁 第2頁

點 號	縱 線(M)	橫 線(M)	距 離(M)	備 註
R35	2552846.478	207811.998		
	(2553054.312)	(206984.214)		
M108	2552434.658	207364.274	77.904	
	(2552642.506)	(206536.476)	(77.904)	
C227-1	2552493.578	207313.309		
	(2552701.428)	(206485.513)		
M107	2552392.640	207311.661	69.995	
	(2552600.490)	(206483.862)	(69.995)	
M106	2552446.726	207267.231		
	(2552654.577)	(206439.434)		
C1	2552281.667	206911.933	179.185	
	(2552489.525)	(206084.128)	(179.190)	
C2	2552438.930	206997.815		
	(2552646.790)	(206170.017)		
說 明	一、下欄係依市縣建設單位提供之坐標成果。以括弧標示。 二、上欄係依據內政部核定之TWD97@2020坐標系統控制點（二度分帶橫梅氏投影坐標）推算之成果。			

5. 都市計畫樁位指示圖

6. 都市計畫樁位公告圖

7. 都市計畫樁位圖

113年度高雄市甲仙區地籍圖重測區都市計畫樁位圖

1

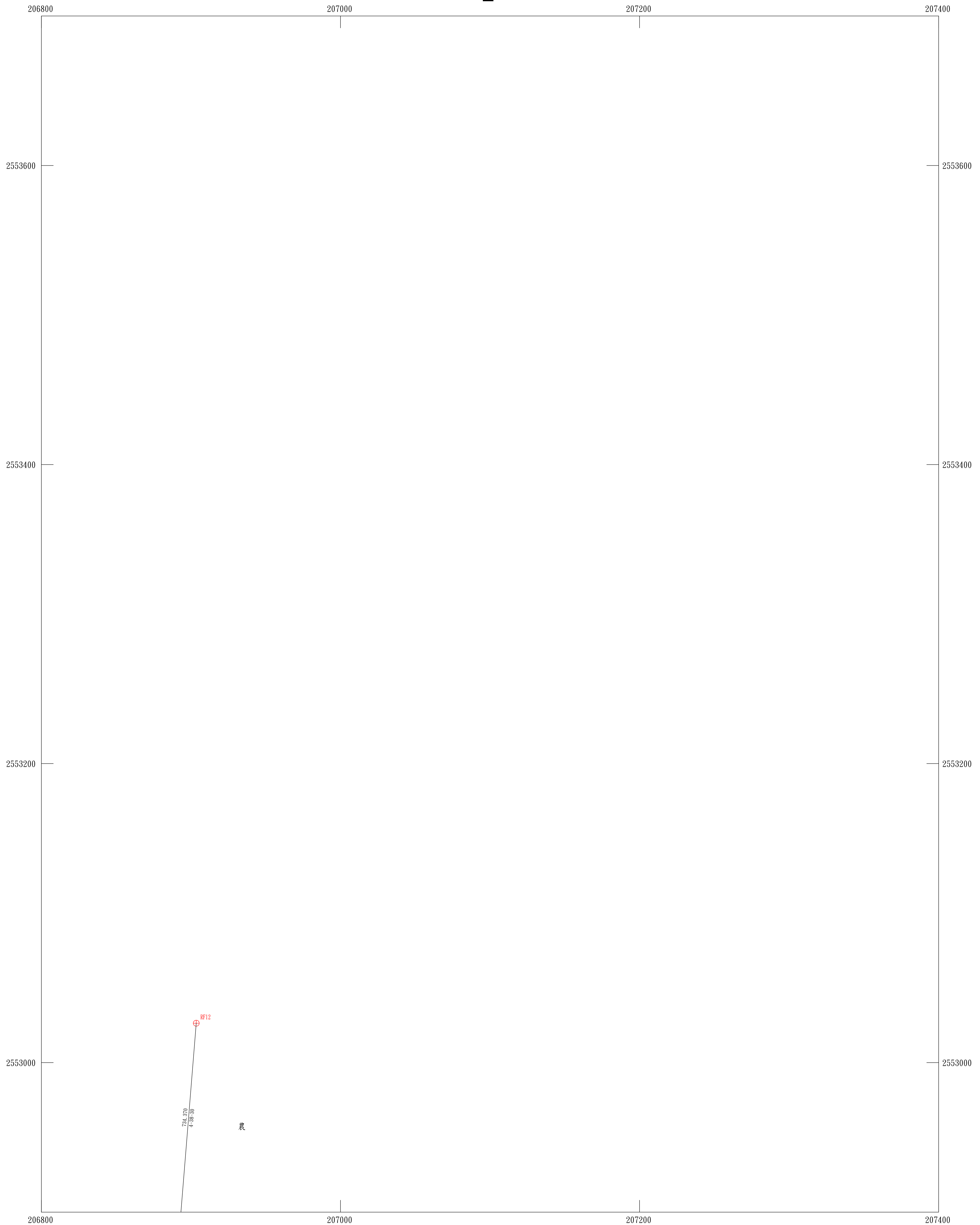

大地基準：臺灣大地基準(TWD97)，採用GRS80參考橢球
 測製時間：中華民國 113 年 5 月
 測製單位：高雄市政府地政局土地開發處

比例尺：1/1000

- 中心樁
- ⊕ 虛樁
- ⊗ 副樁
- ⊕ 分區界樁
- ⊗ 都市範圍界樁

	1	
	2	3

113年度高雄市甲仙區地籍圖重測區都市計畫樁位圖

3

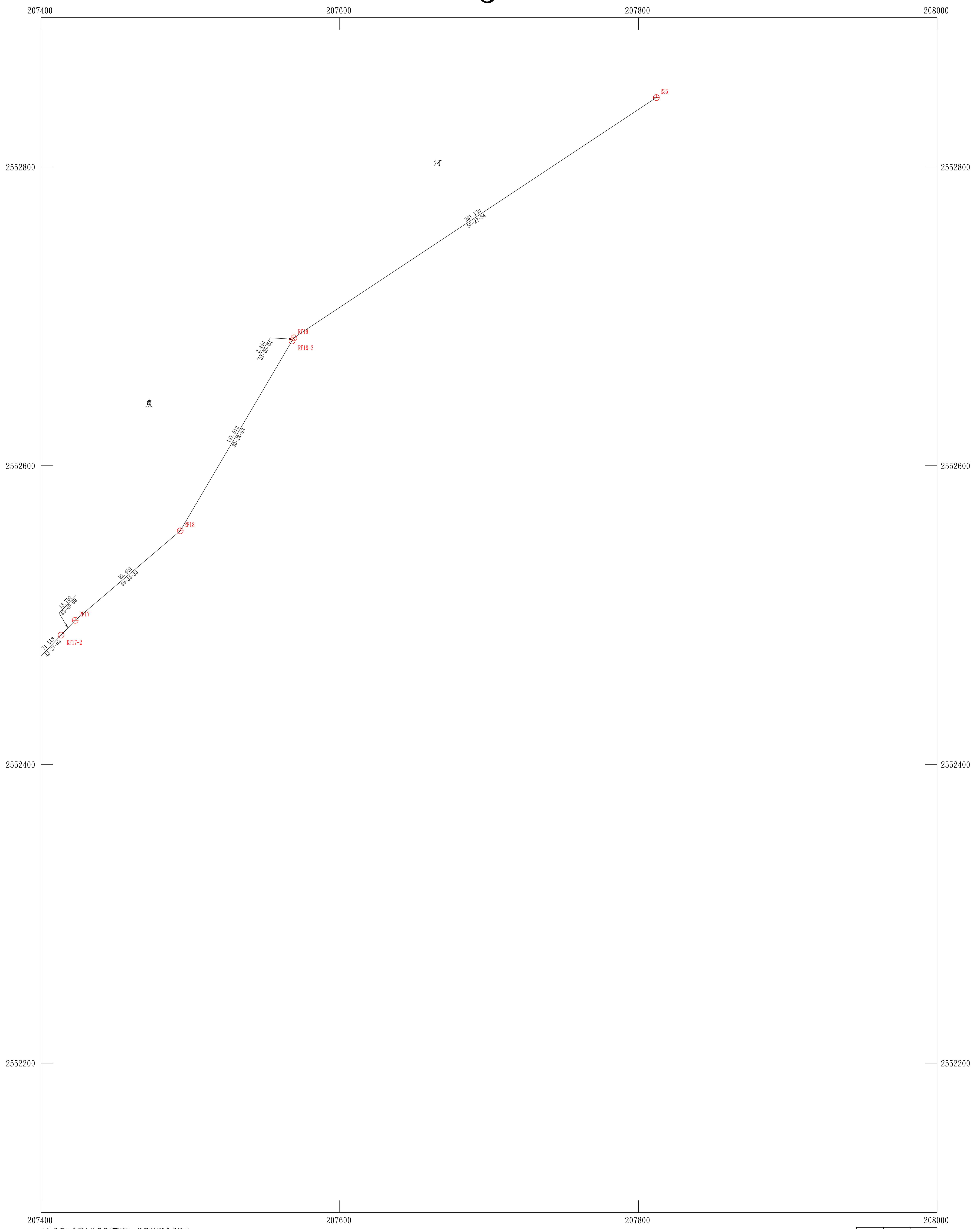

大地基準：臺灣大地基準(TWD97)、採用GRS80參考橢球
 測製時間：中華民國 113 年 5 月
 測製單位：高雄市政府地政局土地開發處

比例尺：1/1000

- 中心樁
- ⊕ 虛樁
- ⊗ 副樁
- ⊙ 分區界樁
- ⊚ 都計範圍界樁

1		
2	3	